

REVISIONS			
REV	DESCRIPTION	DATE	APPROVED
C	REACTIVATED AS PER REV "A" TO SHOW AEROQUIP DESIGN	2006-05-12 RHJ/KBM	EN-F30034 DP-1299
D	ADDED MARKING FOR CRIMPING LOCATION. UPDATED DRAWING ACCORDINGLY. 1) ADDED NOTE #4 2) ADDED DIMENSION. 3) WAS Ø12.7 [.50] REF HOLE	2021-11-16 DMK/ARK	CO-0221372

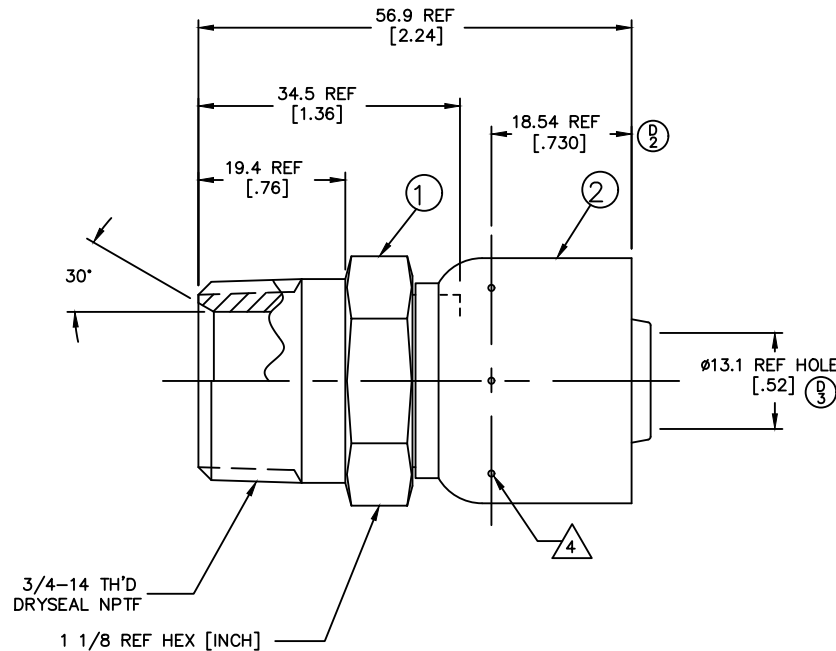

METRIC

FJ3152-1212S	FW1260-1212S	FW1186-12S			
PART NUMBER	① NIPPLE	② SOCKET			
LIST OF MATERIALS					
ITEM NO.	MATERIAL	DRAWN LoTanya Wraagas	FLUID CONVEYANCE DIVISION DRAWING TITLE FITTING ASSEMBLY MALE PIPE, 1503 HOSE		
1	STEEL	CHECKED R. D. WEBB			
2	STEEL	APPROVED R.D.GARRETT			
		RELEASE DATE 2000-05-23			
		EN-F19881	SIZE A2	DRAWING NUMBER FJ3152-1212S	REV D
		DP-1290	SCALE 2/1	DIST U	GAGE CODE 01276
		THIRD ANGLE PROJECTION	SHEET 1		
<small>THE REPRODUCTION, DISTRIBUTION AND UTILIZATION OF THIS DOCUMENT AS WELL AS THE COMMUNICATION OF ITS CONTENTS TO OTHERS WITHOUT EXPLICIT AUTHORIZATION IS PROHIBITED. OFFENDERS WILL BE HELD LIABLE FOR THE PAYMENT OF DAMAGES. ALL RIGHT RESERVED IN THE EVENT OF THE GRANT OF A PATENT, UTILITY MODEL OR DESIGN. (PER ISO 16016)</small>					

- ④ CRIMP LOCATION IMPRESSION MARK (6-8 PLACES) ①
- 3. DIMENSIONS ARE IN MILLIMETERS [INCHES].
- 2. THERE SHOULD BE NO SOCKET MOVEMENT ON THE NIPPLE AFTER CRIMPING.
- 1. CRIMP SOCKET PER ES 2409P17.