

DISPLACEMENT CODE	G MAX
022	5.45/138,5
028	5.45/138,5
035	5.60/142,3
045	5.60/142,3
059	5.72/145,3
073	5.85/148,6
089	5.99/152,2
097	6.06/154,0
113	6.20/157,5
141	6.45/163,9
179	6.79/172,5
226	7.20/182,9

SYM	REVISION	BY	DATE	ECN
A	ENGINEERING RELEASE	RLL	11-10-87	14736
B	-1)<3C>3.25/82,6 MAX WAS 3.21/81,6 MAX-2)<2C>REMOVED 3.31/84,1 Ø MAX -3)<2B>ADDED 3.36/85,4 MAX	DPR	12-13-89	18329
C	-1)<3C> 3.21/81,6 WAS 3.25/82,6 -2) <2B> 3.31/84,1 WAS 3.36/85,4	LK	10-9-90	19520
D	REVISED PICTORIALY	AGJ	4-7-92	22077
E	REVISED PICTORIALY	AGJ	8-27-92	22674
F	<4B>.535+0.015/-0.005/13.59+0.38/-0.13 Ø WAS .535±0.005/13.59±0.13 Ø	AGJ	1-28-02	39853
G	-1)<4C>WAS 5.17/131,4 MAX -2)<4B>WAS 3.81/96,8 MAX	SJP	04-07-04	46856
H	-1)<4A>REMOVED NOTE 4 -2)<4D> REMOVED MODEL CODE COLUMN AND REPLACED DISP. IN/REV TO DISP. CODE -3)<5A>MOUNTING FLAGE DP. CODE WAS "A" -4)CASE DRAWIN DP. WAS "0"	PRK	06-30-08	ECR 10496
J	<1C> REMOVED Danfoss LOGO	SSD	04-23-21	0131343

FOR SHAFT CONFIGURATION SEE SEPARATE SHAFT DRAWINGS.

GROOVE PROVIDED FOR 3.25/82,6 I.D. X .103/2,62 CROSS SECTION O-RING. (DASH NO. 152)

FOR PORT CONFIGURATION SEE SEPARATE PORT DRAWING PORT B

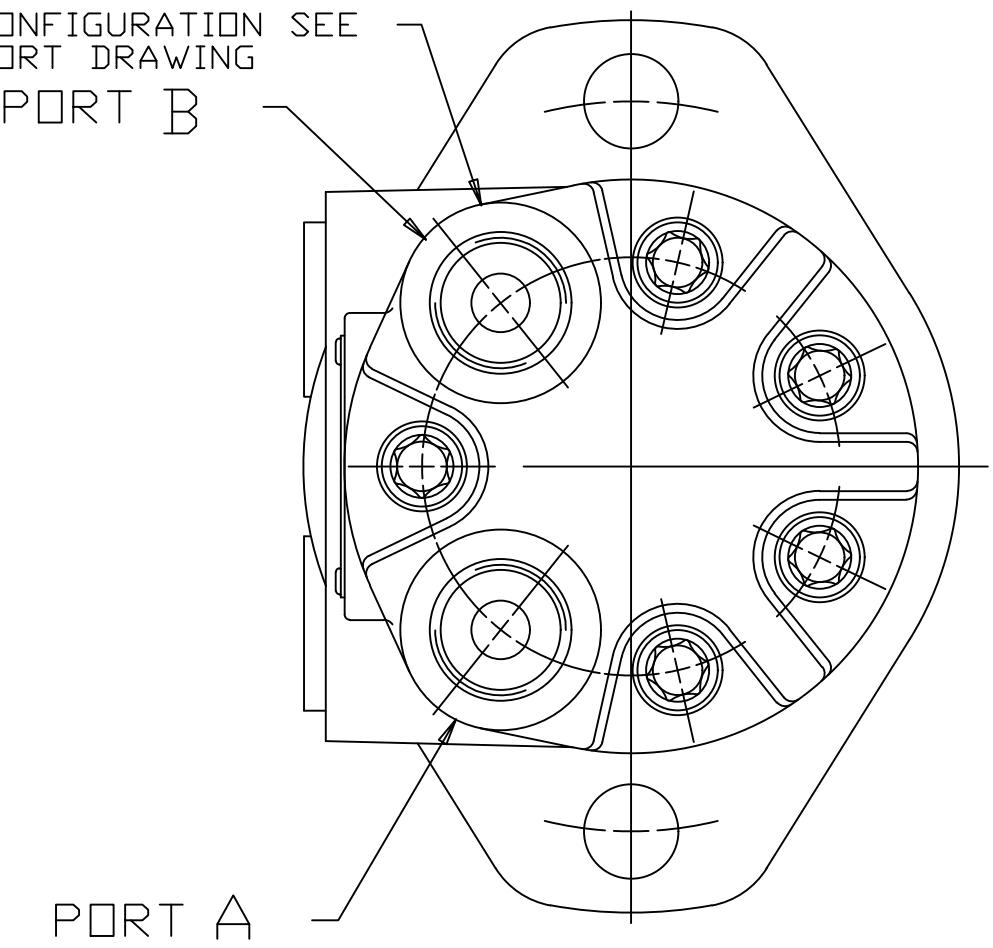
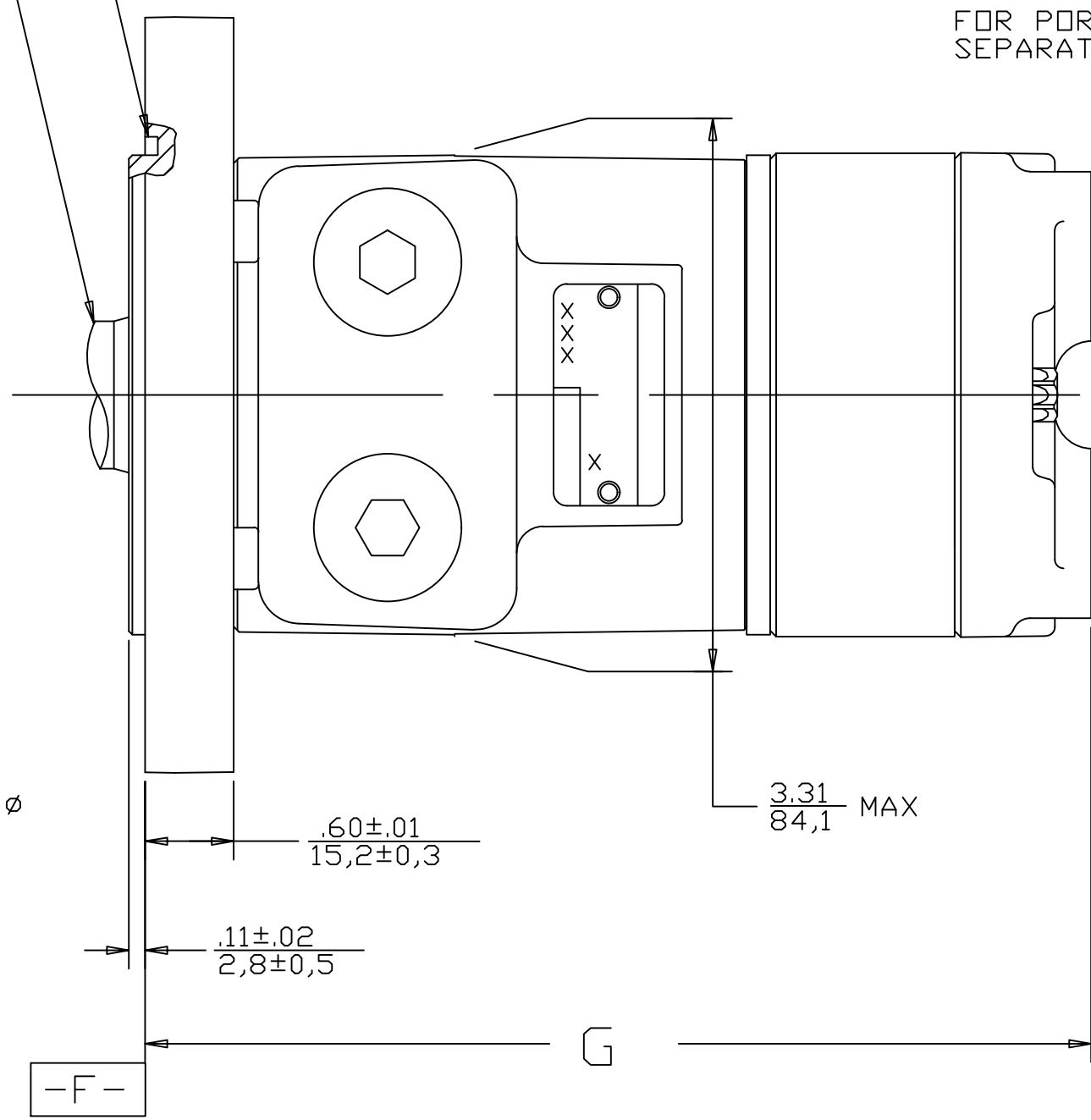
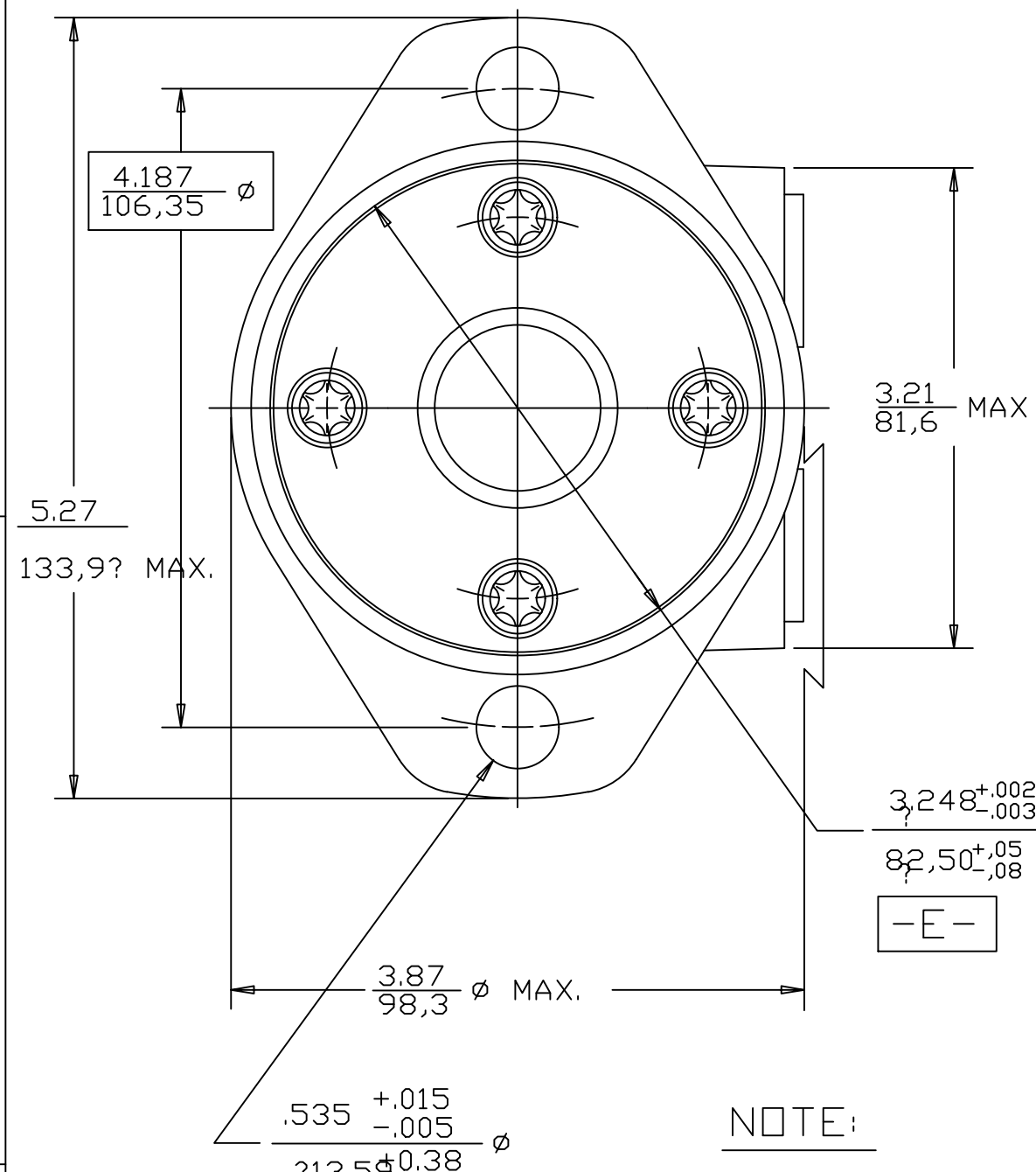

- NOTE:
1. ROTATION: STANDARD; WHEN FACING SHAFT END OF MOTOR, SHAFT TO ROTATE CLOCKWISE WHEN PORT "A" IS PRESSURIZED. COUNTERCLOCKWISE WHEN PORT "B" IS PRESSURIZED. REVERSE ; WHEN FACING SHAFT END OF MOTOR, SHAFT TO ROTATE CLOCKWISE WHEN PORT "B" IS PRESSURIZED. COUNTERCLOCKWISE WHEN PORT "A" IS PRESSURIZED.
 2. MOUNTING FLANGE: AA = 2 BOLT STD: 3.25/82,6 DIA. X .12/3,0 PILOT, .535/13,59 DIA. MOUNTING HOLES ON 4.18/106,2 DIA. B.C.
 3. CASE DRAIN: 00 = NO CASE DRAIN
 - 4.

NOTICE TO PERSONS RECEIVING THIS DRAWING AND / OR TECHNICAL INFORMATION

THE REPRODUCTION, DISTRIBUTION, AND UTILIZATION OF THIS DOCUMENT, AS WELL AS THE COMMUNICATION OF ITS CONTENTS TO OTHERS WITHOUT EXPLICIT AUTHORIZATION IS PROHIBITED. OFFENDERS WILL BE HELD LIABLE FOR THE PAYMENT OF DAMAGES. ALL RIGHTS RESERVED IN THE EVENT OF THE GRANT OF A PATENT, UTILITY MODEL, OR DESIGN. (PER ISO 16016)

© 2008 Danfoss Corporation - All Right Reserved



REVIEWED FOR CLASSIFICATION PER ESP-042

THE REPRODUCTION, DISTRIBUTION, AND UTILIZATION OF THIS DOCUMENT, AS WELL AS THE COMMUNICATION OF ITS CONTENTS TO OTHERS WITHOUT EXPLICIT AUTHORIZATION IS PROHIBITED. OFFENDERS WILL BE HELD LIABLE FOR THE PAYMENT OF DAMAGES. ALL RIGHTS RESERVED IN THE EVENT OF THE GRANT OF A PATENT, UTILITY MODEL, OR DESIGN. (PER ISO 16016)			
DRAWN BY/DATE	RLL 10-20-87	MATERIAL/HEAT TREAT	
CHECKED BY/DATE	KQ 1-21-88		
ENGRG BY/DATE	WCW 1-25-88	TITLE	H MOTOR INSTALLATION
DO NOT SCALE			
THIRD ANGLE	PROJECTION	LINEAR MEASUREMENT IN/MM IN/IN	NUMBER A-37-312
		SCALE	FULL SIZE SHEET 1 OF 1